

8	Expansion screws
7	Water inlet rubber plug
6	Expansion screws
5	Plum blossom head screw with needles
4	Hanging piece
3	Floor drain adapter
2	Sealing plate
1	Toilet Body

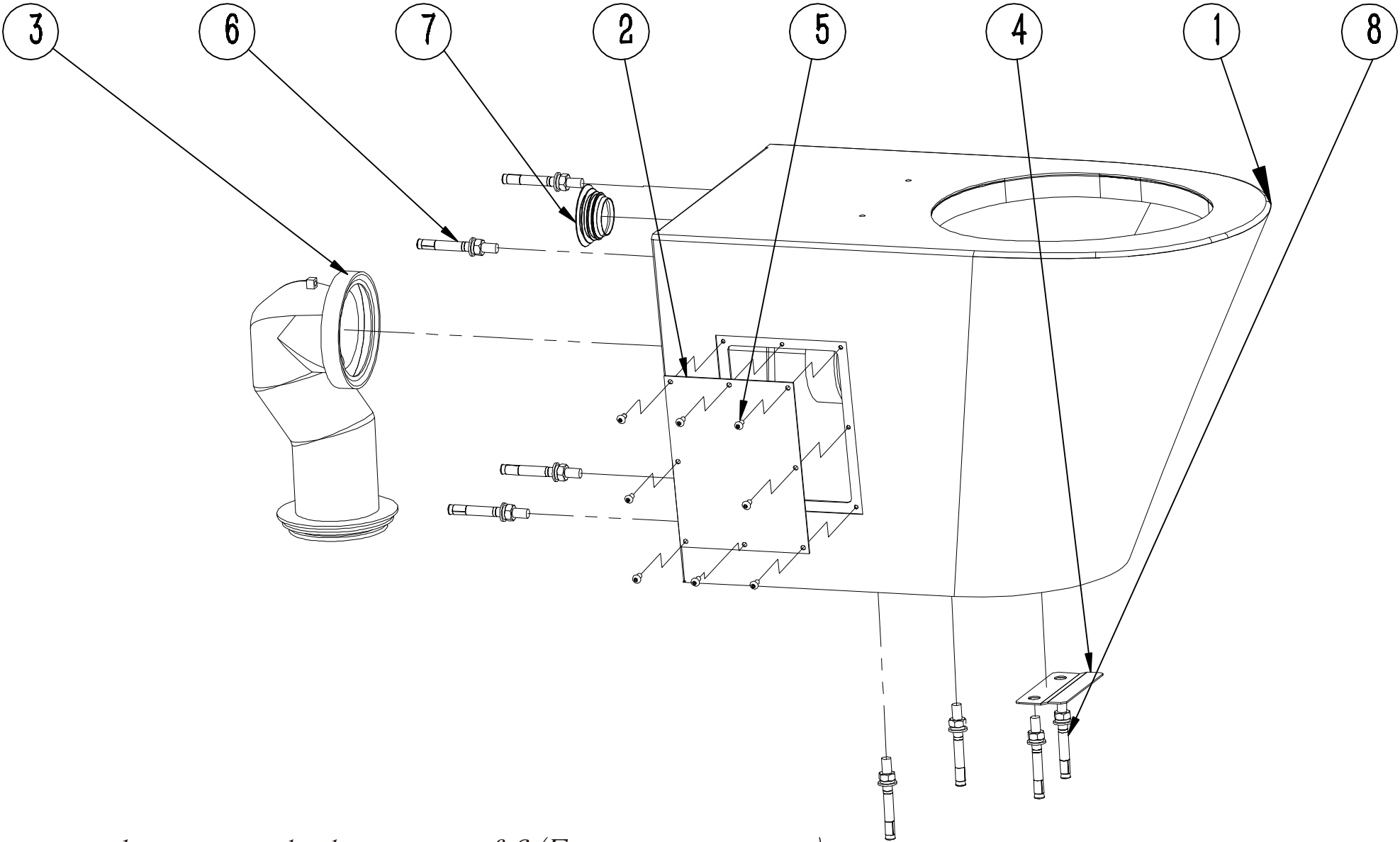

*Toilet Installation Instructions*

- 1. Place 1 (Toilet Body) at the desired location, determine the locations of 6 (Expansion screws) and 4 (Hanging piece), and drill holes.*
- 2. Install 4 (Hanging plates) with 8 (Expansion screws).*
- 3. Install 7 (Water inlet rubber plug) at the water inlet and 3 (Floor drain adapter) at the drain hole*
- 4. Fix 1 (Toilet Body) and use 4 (Hanging plates) and 6 (Expansion screws)*
- 5. Install 2 (Sealing plate) with 5 (Plum blossom head screw with needles)*

Company Name	XINHE STAINLESS STEEL PRODUCTS CO.,LTD.
Product Name	Stainless steel Toilet ( Installation Instructions )
Model Number	PQ 565
Material	SUS 304# Satin Finish